

**Model Number**  
**RMCS-2078**

## Planetary Geared DC Motor 380Kgcm 10RPM 100W

### Mechanical Drawing (Dimensions are in mm)

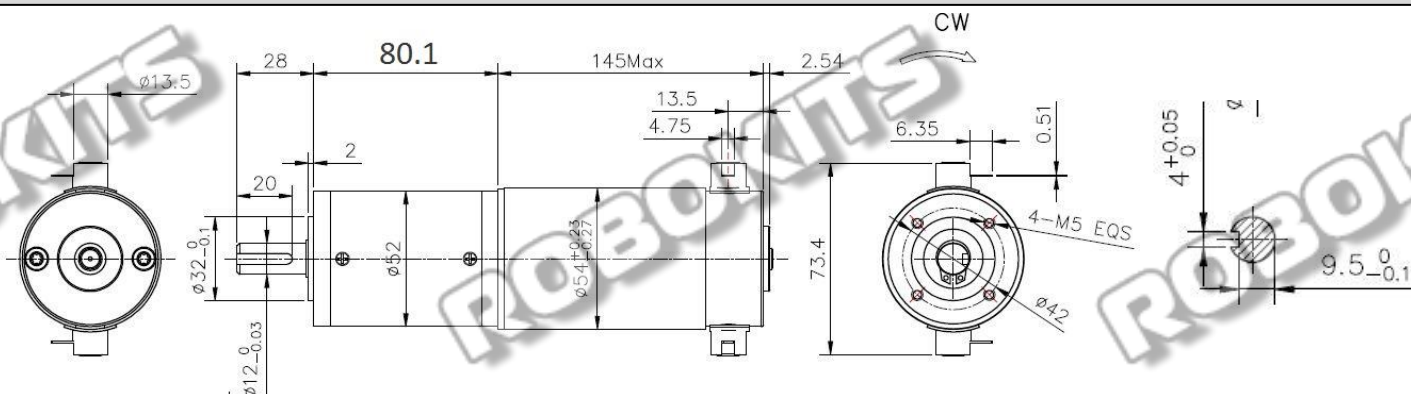

### Technical specifications of Motor

Motor Type	Planetary Geared DC Motor
Operating voltage	24V DC
Motor Speed at Output Shaft (RPM)	10RPM
Gear ratio	1 : 276
Rated Torque(Kgcm)	380Kgcm
Shaft Dia	12mm
Weight	2.0Kg

### Electrical Connections

+VCC	RED
GND	BLK

### Base Motor Specifications

Nominal voltage	24 VDC
No load speed	2800 RPM
Rated torque	0.35 N-m
Output power	104 W

