

Model Number
RMCS-2076

Planetary Geared DC Motor 40Kgcm 210RPM 100W

Mechanical Drawing (Dimensions are in mm)

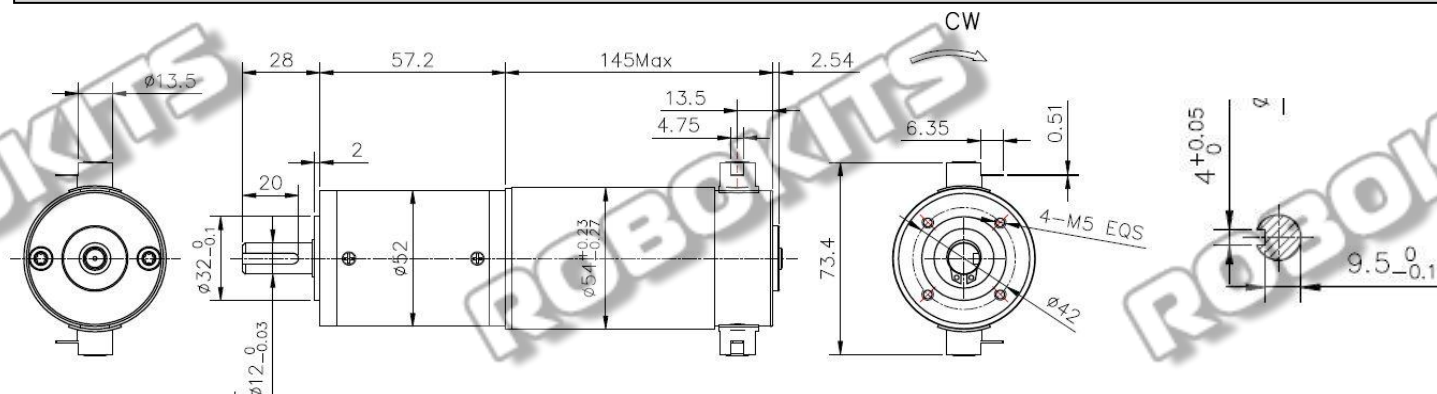

Technical specifications of Motor

Motor Type	Planetary Geared DC Motor
Operating voltage	24V DC
Motor Speed at Output Shaft (RPM)	210RPM
Gear ratio	1 : 13
Rated Torque(Kgcm)	40Kgcm
Shaft Dia	12mm
Weight	1.8Kg

Electrical Connections

+VCC	RED
GND	BLK

Base Motor Specifications

Nominal voltage	24 VDC
No load speed	2800 RPM
Rated torque	0.35 N-m
Output power	104 W

