

Model Number
RMCS-2075

Planetary Geared DC Motor 10Kgcm 750RPM 100W

Mechanical Drawing (Dimensions are in mm)

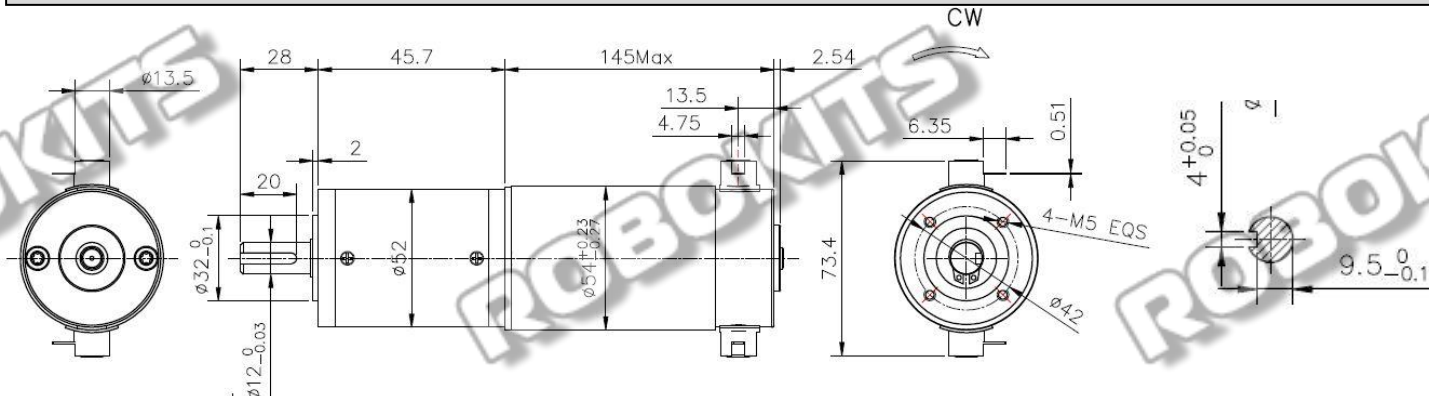

Technical specifications of Motor

Motor Type	Planetary Geared DC Motor
Operating voltage	24V DC
Motor Speed at Output Shaft (RPM)	750RPM
Gear ratio	1 : 3.6
Rated Torque(Kgcm)	10Kgcm
Shaft Dia	12mm
Weight	1.5Kg

Electrical Connections

+VCC	RED
GND	BLK

Base Motor Specifications

Nominal voltage	24 VDC
No load speed	2800 RPM
Rated torque	0.35 N-m
Output power	104 W

